



Front and Rear Sway Bar Installation Instructions

Covers Part #10295

Kit contents:

- Sway bars
 - Red color band, 3.0mm (stiff)
 - Green color band, 2.8mm (stiff)
 - Yellow color band, 2.5mm (intermediate)
 - Black color band, 2.3mm (intermediate)
 - Blue color band, 2.0mm (soft)
- Front or rear linkages (4)
- Front sway bar mount

- Rear sway bar mount
- 3x6mm FCS (4)
- 3x15mm BCS (4)
- 3x3mm GS (4)

Tools required:

- 1.5mm hex wrench
- 2.0mm hex wrench
- 2.5mm hex wrench

	Front Sway Bar	Rear Sway Bar
Reduce Understeer	Soften	Stiffen
Reduce Oversteer	Stiffen	Soften
Smoother / High Grip	Stiffen	Stiffen
Rougher / Lower Grip	Soften	Soften
Severe Terrain	Remove	Remove

Fig 1 Front Hinge Pin Retainer Removal

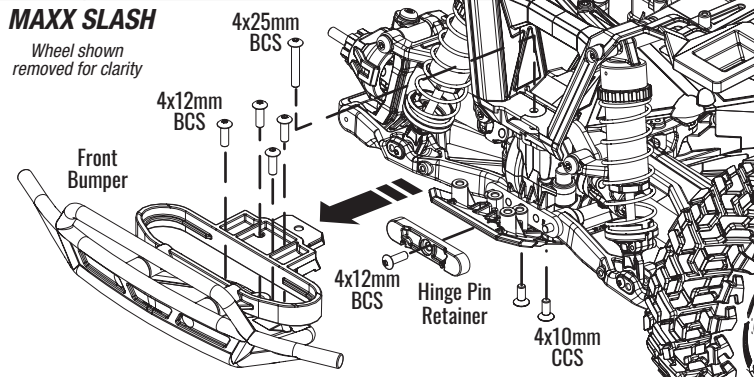

Fig 2 Rear Hinge Pin Retainer Removal

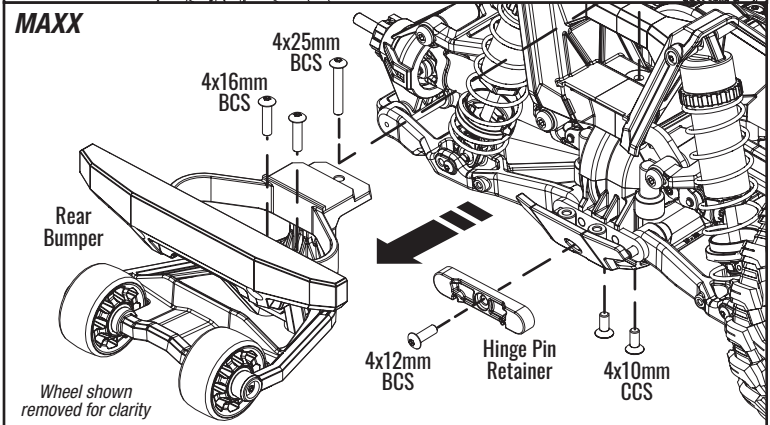
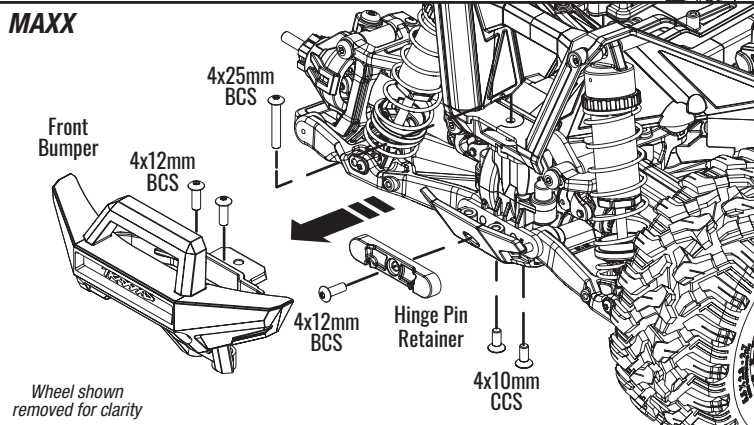
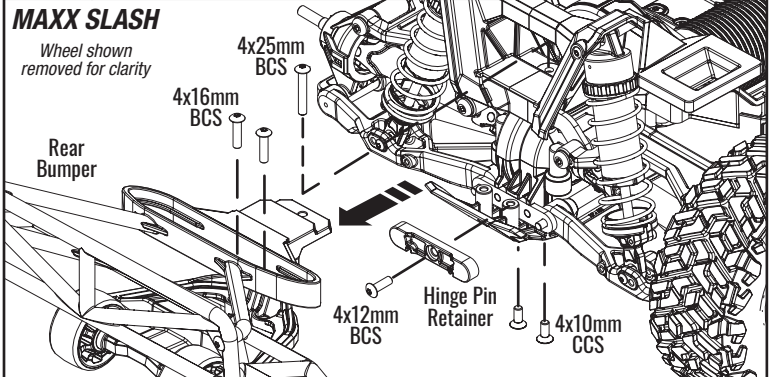

Fig 3 Front Sway Bar Install

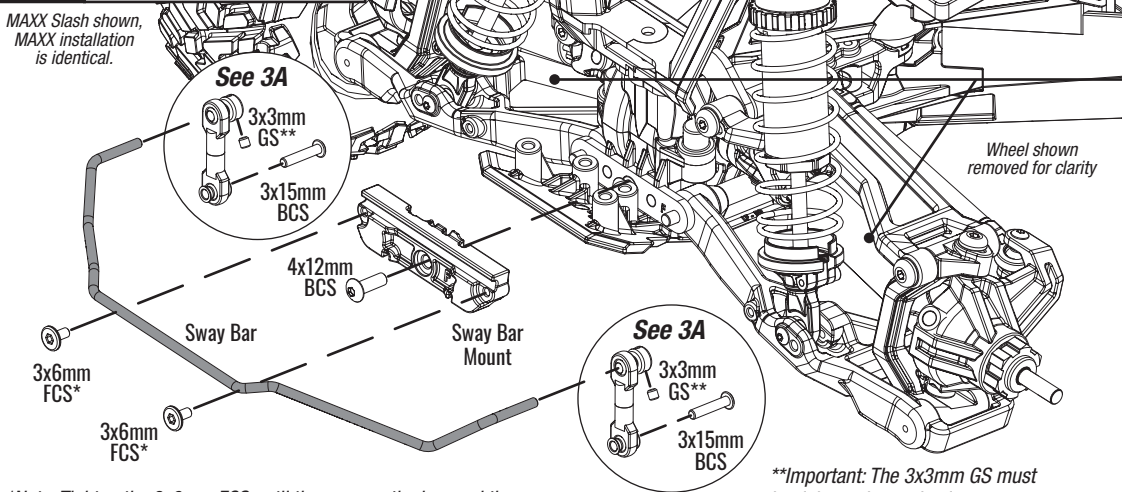

Fig 3A

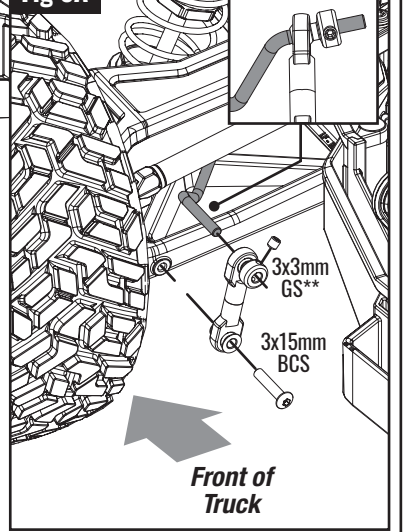

Fig 4 Rear Sway Bar Install

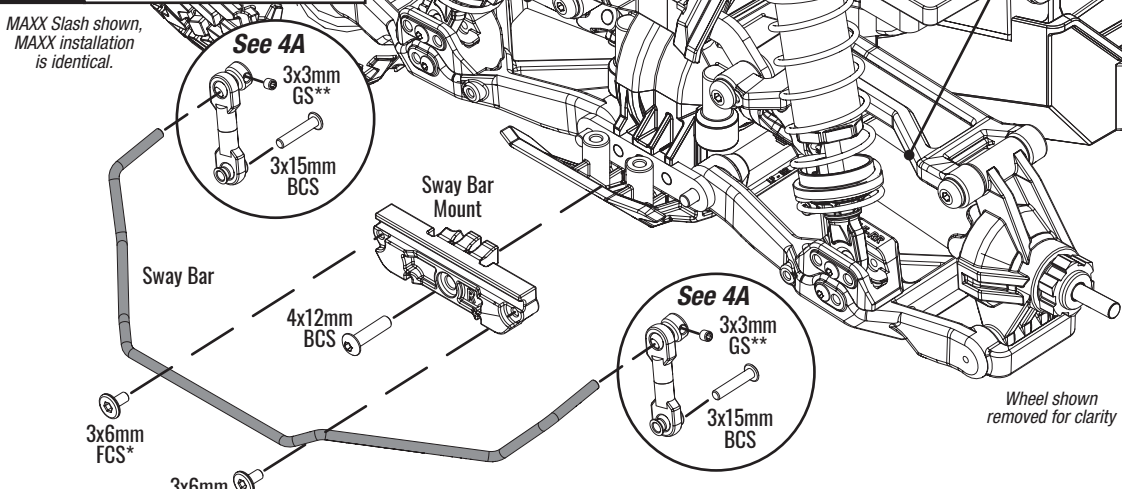
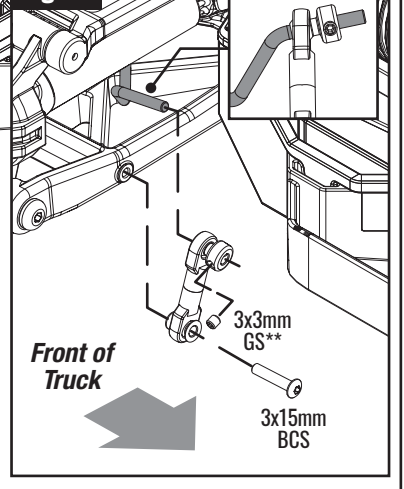

Fig 4A



****Important: The 3x3mm GS must be tightened completely to secure the sway bar to the vehicle.**

If you have questions or need technical assistance, call Traxxas at
1-888-TRAXXAS
 (1-888-872-9927) (U.S. residents only)