



* You can download the latest version of an instruction manual for this model by visiting www.academyhobby.com, clicking the link for "INSTRUCTION & DOWNLOAD" and entering the item number. 본 제품의 조립 중 궁금한 점은 www.academy.co.kr 검색 후 메뉴 "자료실" → "프러모탈" 포 이용하여 해당 제품명을 입력하면 최신의 설명서를 확인 할 수 있습니다.

Warning in Assembly of Model Kits Take care not to injure yourself while using the modeling tools to cut or trim parts. 공구를 이용하여 부품을 다듬고 자를 경우 손을 다치지 않도록 주의를 기울여 주십시오.

CAUTION!
주의

<조립하기 전에>
부품을 조립하기 전에 설명서를 잘 읽어보거나 꼭 확인하십시오.
설명서가 없거나 부품을 맞추어 확인한 후 조립합니다.
부품을 다듬을 때에는 반드시 사포나 깎는 도구로 깎으십시오.
공작계를 사용할 때는 사용법이 없는 곳에 주의하고 너무 강하게 비틀지 않도록 합니다.
에어를 건조시키고 공작계를 사용할 때는 설명서대로 공작을 사용하고 공기를 잘라냅니다.
사용 후 남은 부품은 어린이의 손에 닿지 않도록 잘 보관하십시오.

<Read this before you begin>
Study the instructions before assembly.
Check the fit of each piece before cementing into place.
Never use cement or paint near open flame.
Do not use too much cement to join parts.
*Open a window or make area well ventilated when cement or paint is in use.
*Put up and frame away the empty plastic bags to avoid danger of suffocation for little children.

CEMENT 점착제	CEMENT 점착제 금지	X2 수만큼 조립	DECAL 전사지	BALLAST 무게추	PE 매칭	FILL 채움
CUT 절리칼	OPTION 선택	OPPOSITE 반대쪽	HOLE 볼어음	CAUTION 주의	INSTANT CEMENT 순간 점착제	VER-1 버전

MAIN COLOR	DARK YELLOW				DARK GREEN				RED BROWN			
	Number	Color	Material	Quantity	Number	Color	Material	Quantity	Number	Color	Material	Quantity
FLAT BLACK	33	33	H12	33	LC02	1289	4098	32108	36058	1900	57	725
STEEL	53	53	H28	28	LC76	1795	4601	32191	36191	863	72	750
WOOD BROWN	10	10	H37	43	LA085	1540		32382	36382	825		782
DARK YELLOW	84		H79	39	LA097	2052	4796	32195	36195	823	31	6
DARK GREEN	86	86	H36	70	LA206	1591	4734	32360	36360	890		172
RED BROWN	160	160	H47	41	LA205	2152	4841	32368	36368	944	41	160
RUST	180		H33	81	LA088	1785	4679	32183	36183	871		700

***Before starting assembly of the tank, make holes on the underside of parts at locations indicated by ●.**
조립을 시작하기 전에 아래부 부품의 밑면을 보고 ● 표시되어 있는 곳에 구멍을 뚫어주세요.

***Refer to page 16 for Zimmet decal application.**
본 전차에 제퍼리트 전사지를 적용 할 경우에는 16페이지를 참고하세요.

1 **CEMENT** 점착제 사용

2 **CEMENT** 점착제 사용

3 **CEMENT** 점착제 사용

***Assemble in numerical order starting with 11**
11번부터 조립합니다.

2 **CEMENT** 점착제 사용

3 **CEMENT** 점착제 사용

4 **CEMENT** 점착제 사용

() is opposite number. ()는 반대쪽 번호입니다.

5 **CEMENT** 점착제 사용

X4 수만큼 조립

X2 수만큼 조립

X16 수만큼 조립

X8 수만큼 조립

X2 수만큼 조립

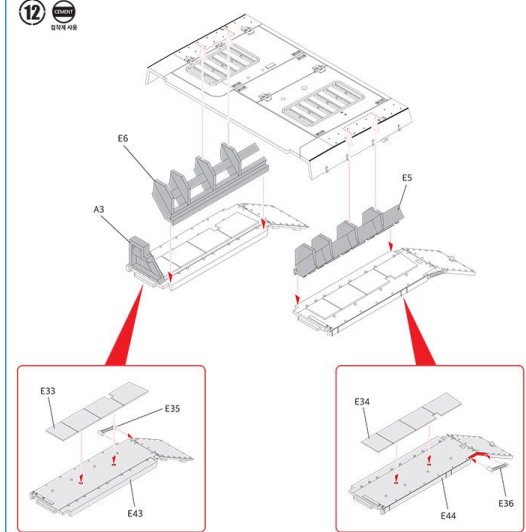
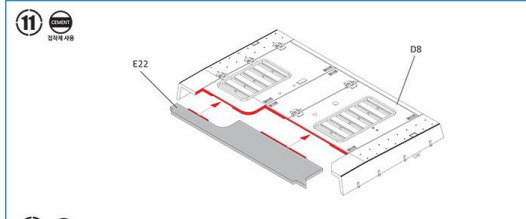
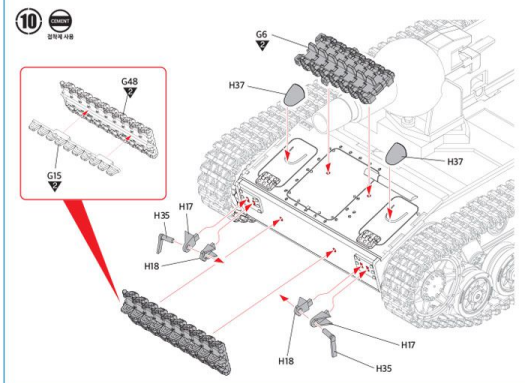
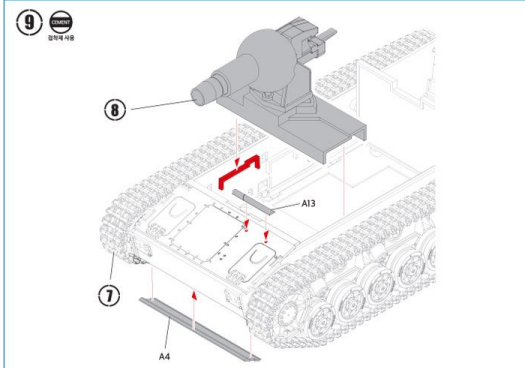
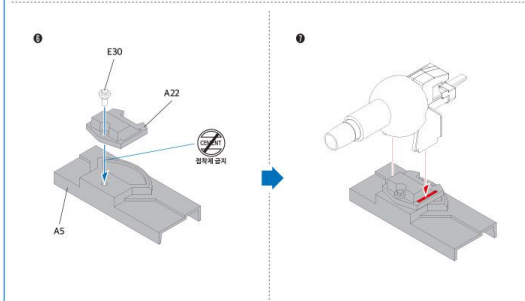
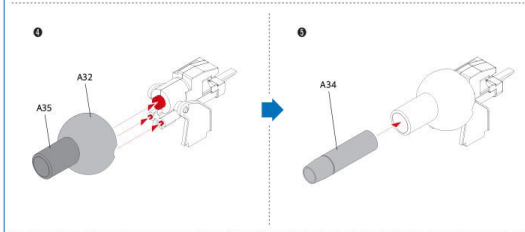
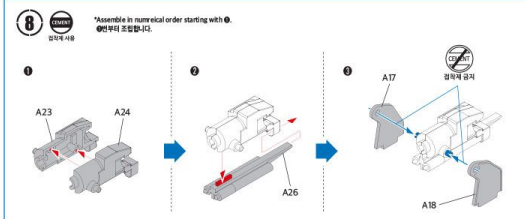
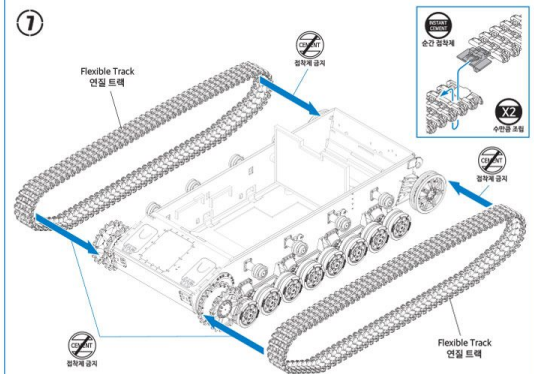
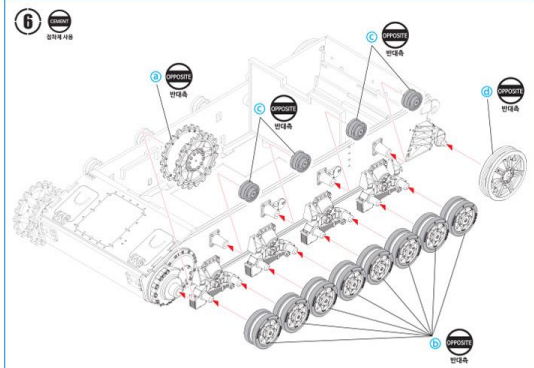

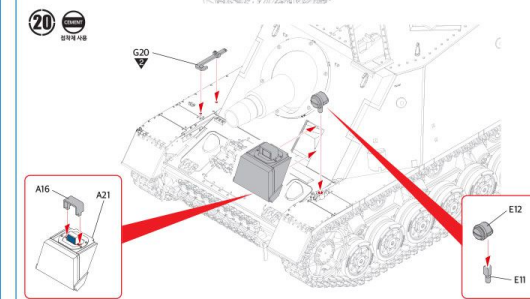
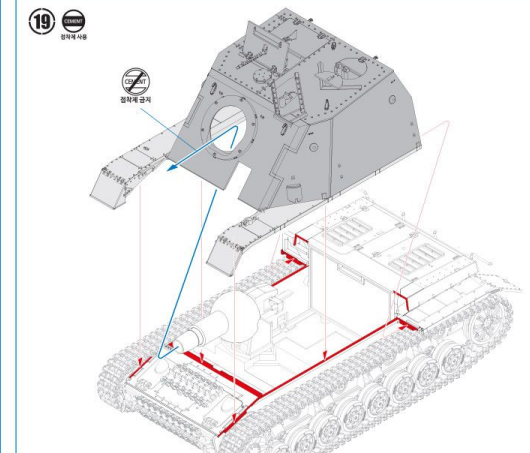
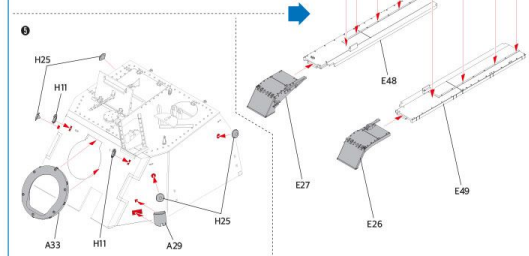
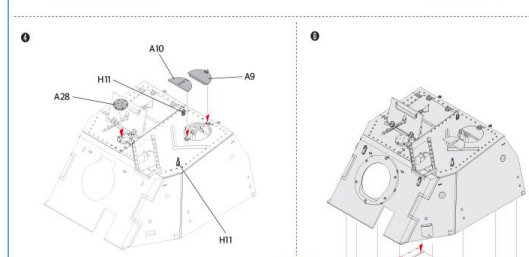
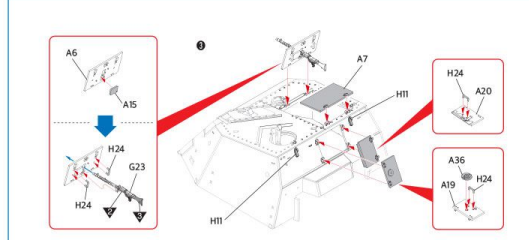
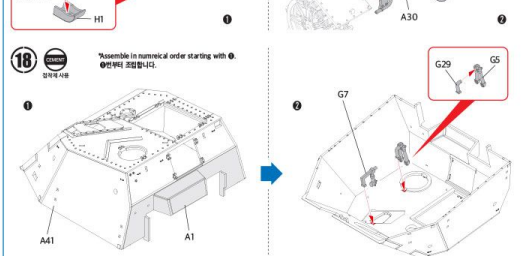
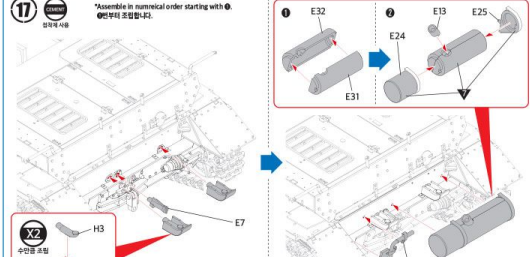
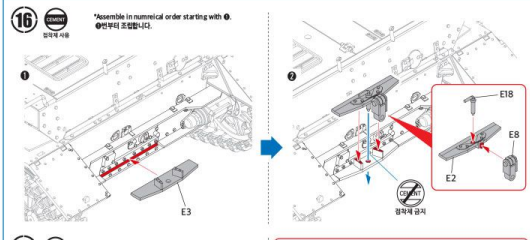
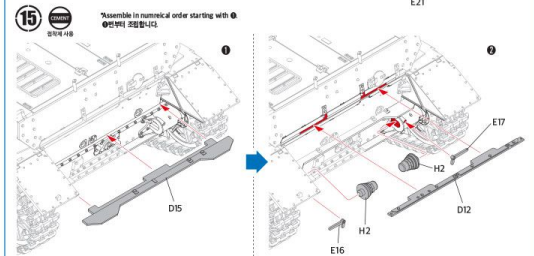
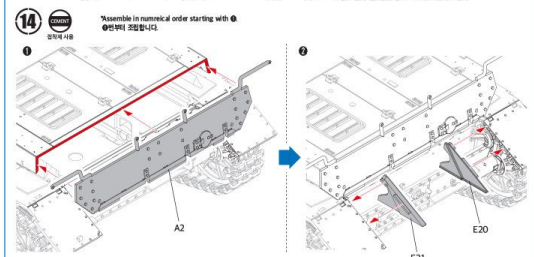
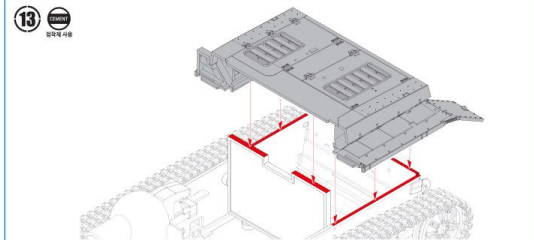

19 CAUTION
주의해 사항

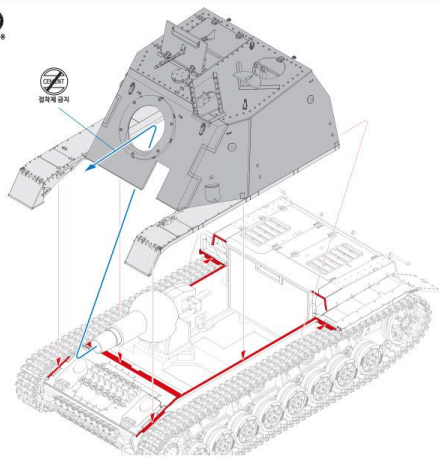

20 CAUTION
주의해 사항

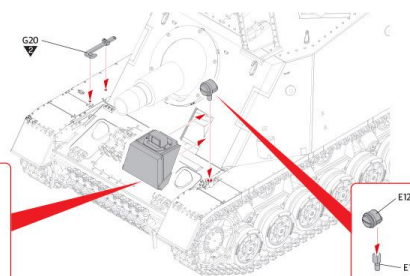
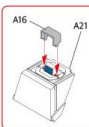

21 CAUTION
주의해 사항

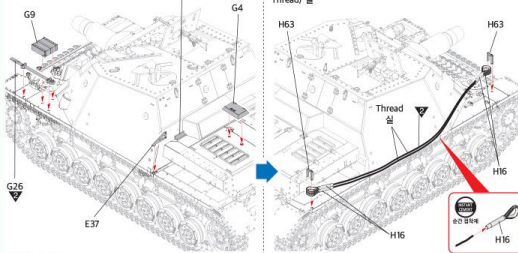

22 CAUTION
주의해 사항

*Assemble in numerical order starting with ❶
*순번부터 조립합니다.

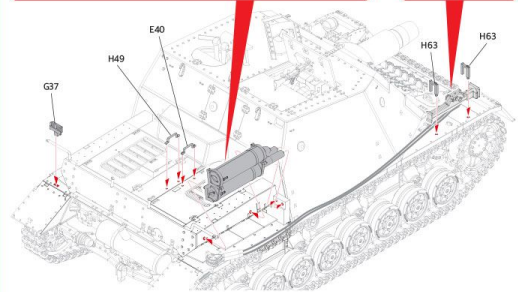
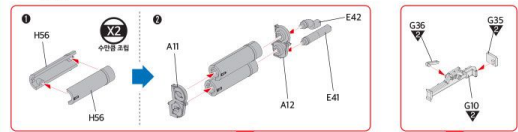

23 CAUTION
주의해 사항

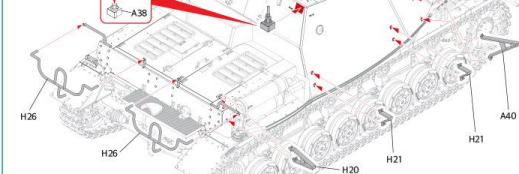

24 CAUTION
주의해 사항

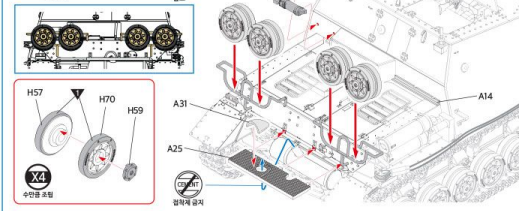

25 CAUTION
주의해 사항

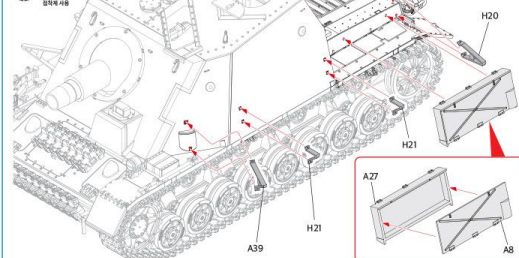

26 CAUTION
주의해 사항

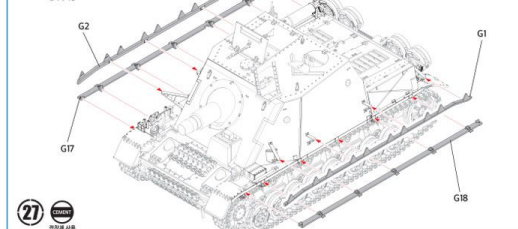

27 CAUTION
주의해 사항

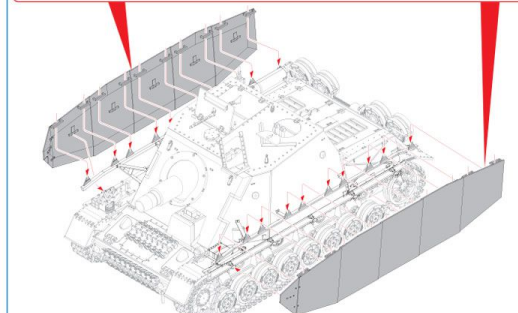
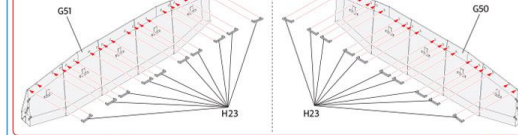

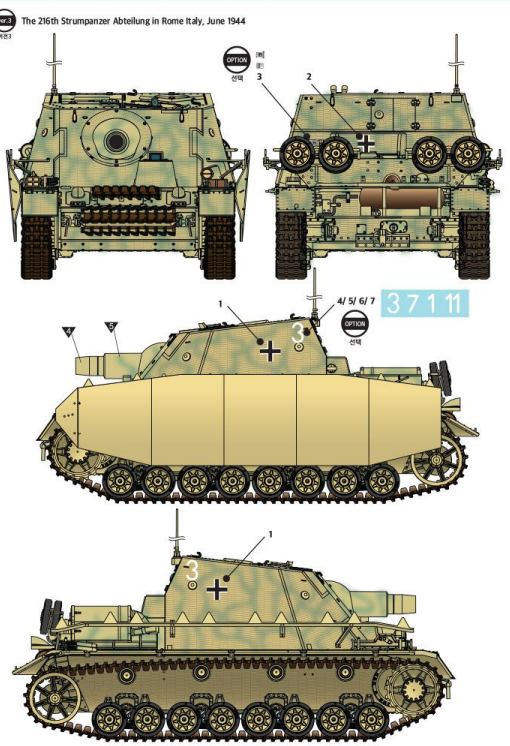
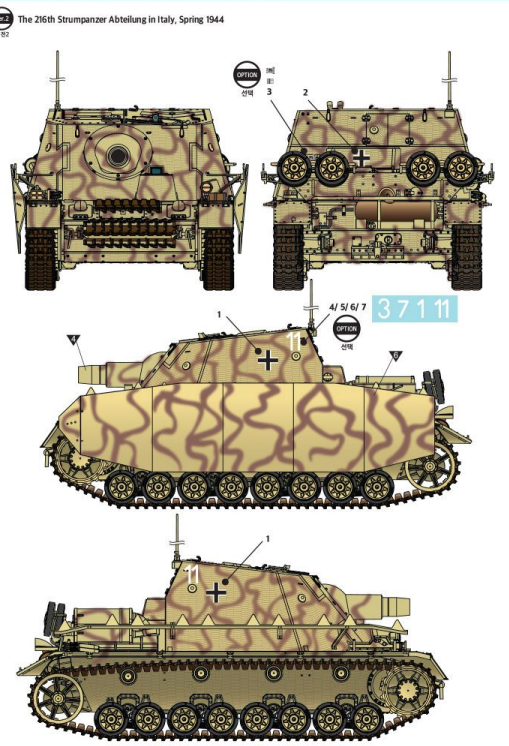
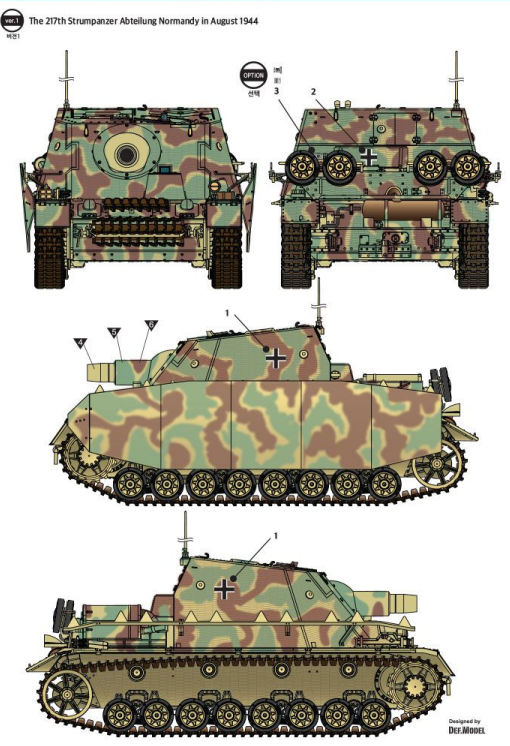
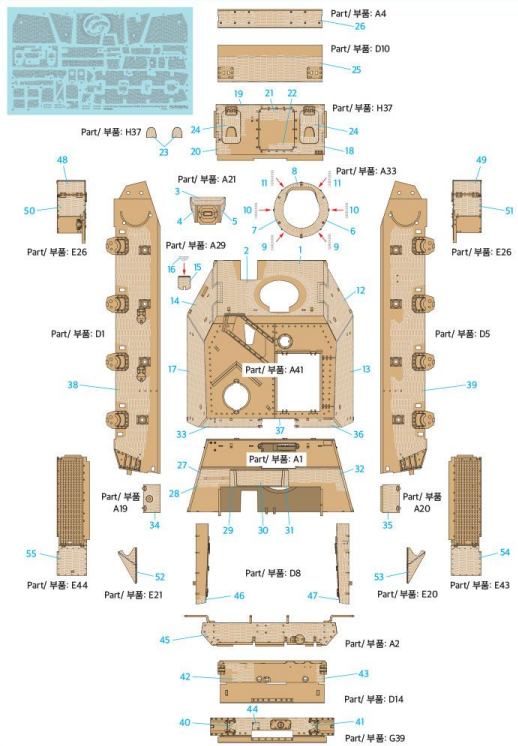

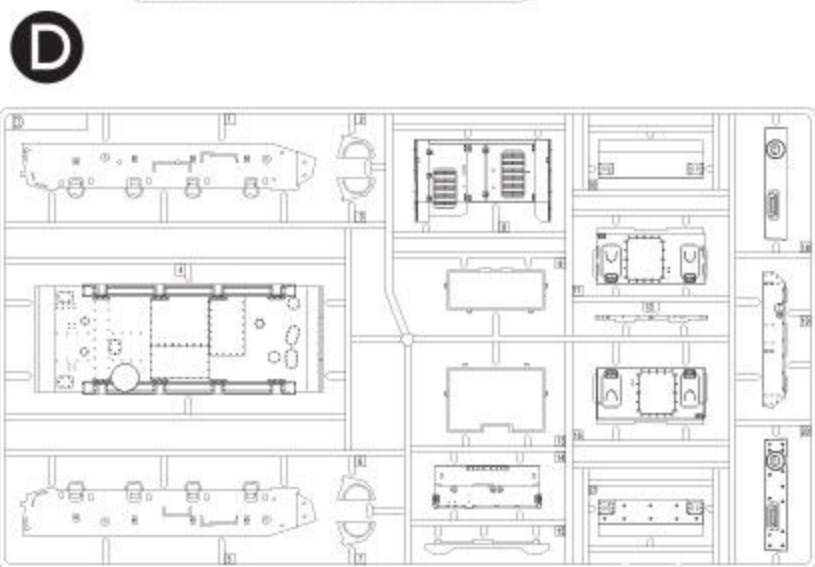
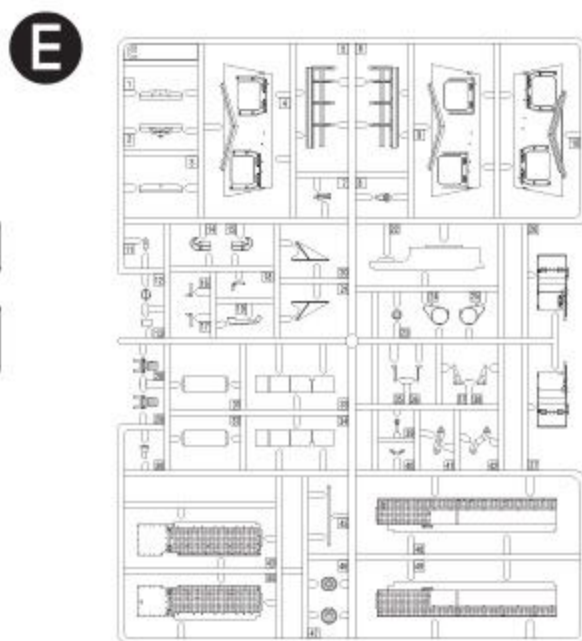
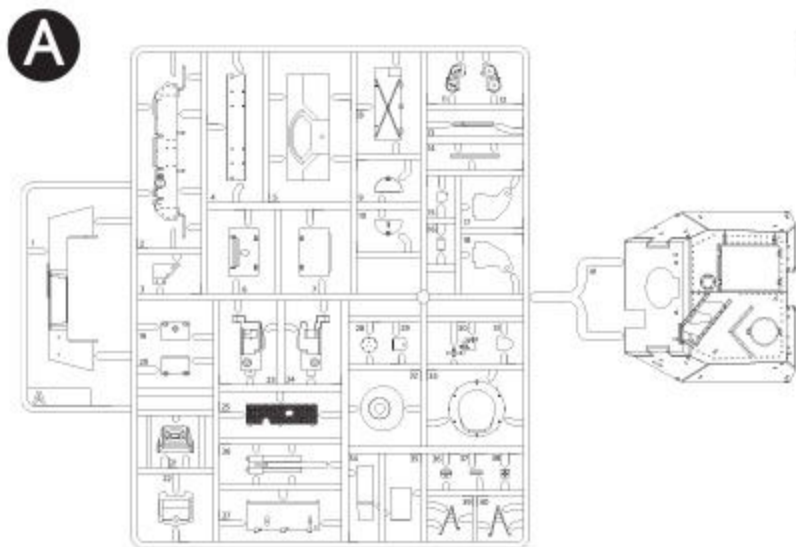

H X4

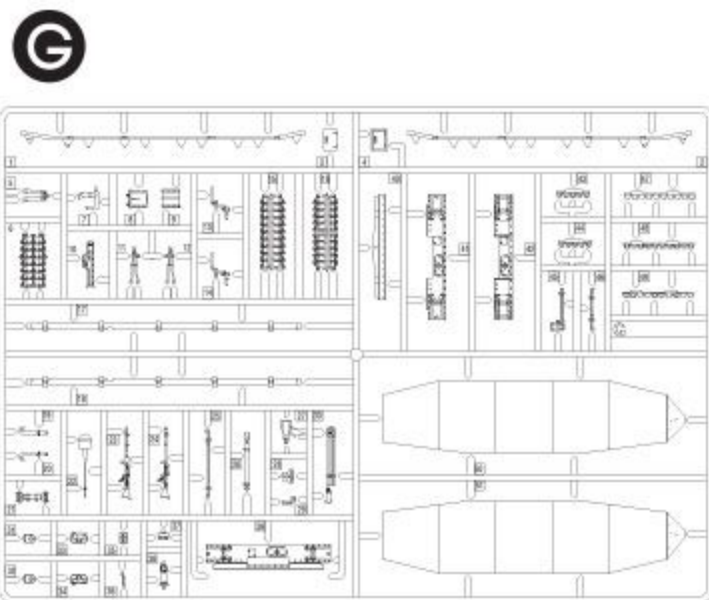
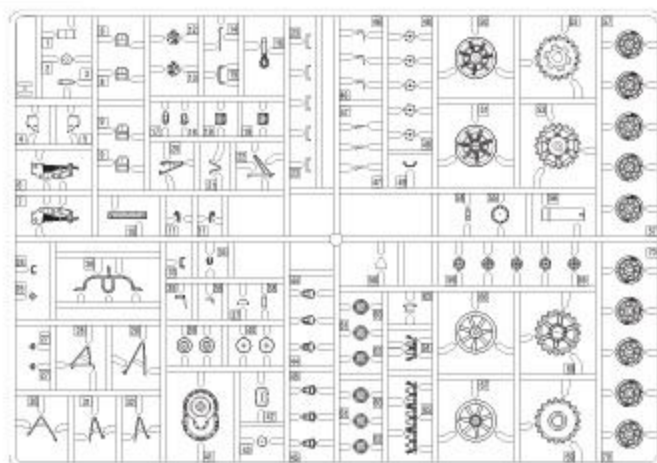

- Decal/ 전사지
- Zimmerit Decal/ 지메리트 전사지
- Flexible Track/ 연결 트랙

● Unused parts/ 불필요 부품

D2, D3, D16, D17, D18, D19, D20, E1, E2, E4, E9, E10, E19, E23, E28, E29, E38, E45, E46, E47, G3, G8, G11, G12, G13, G14, G16, G19, G21, G22, G24, G25, G27, G28, G30, G33, G34, G40, G41, G42, G43, G44, G45, G46, G47, G49, H1X2, H2X2, H3X2, H8, H9, H10, H11X2, H14, H15, H17X2, H18X2, H19, H20X2, H22, H26X2, H27, H28, H29, H30, H31, H32, H33, H34, H35X2, H36, H37X2, H38, H39, H40, H41X2, H42, H43, H44, H45X2, H46, H47, H48, H49X3, H50X2, H51X2, H52, H53, H54, H55X2, H61, H64, H65, H66, H67, H68, H69